

TRUXEDO®

Deuce

by Shur-Co. Automotive Patent Pending

Owner's & Installation Manual

READ INSTRUCTIONS - Failure to assemble cover properly will void warranty.

OWNER'S MANUAL

Deuce



Damaged or missing parts?
Call **1-877-878-9336**
Mon - Fri 8 am - 5 pm CT
Parts will be shipped to you factory direct.
Do not return kit to place of purchase.

Tools Required:
1/2" Socket
9/16" Socket
1/2" Box End Wrench

PICKUP BED COVER

SHUR-CO.
AUTOMOTIVE

P.O. Box 713, 2209 Kellen Gross Dr., Yankton SD 57078
Phone: 1-877-TRUXEDO (1-877-878-9336) Fax: (605) 664-9304
Web Site: <http://www.truxedo.com>

TruXedo® Deuce is a registered United States trademark of Shur-Co. Patents pending.

SIDE RAIL AND COVER INSTALLATION

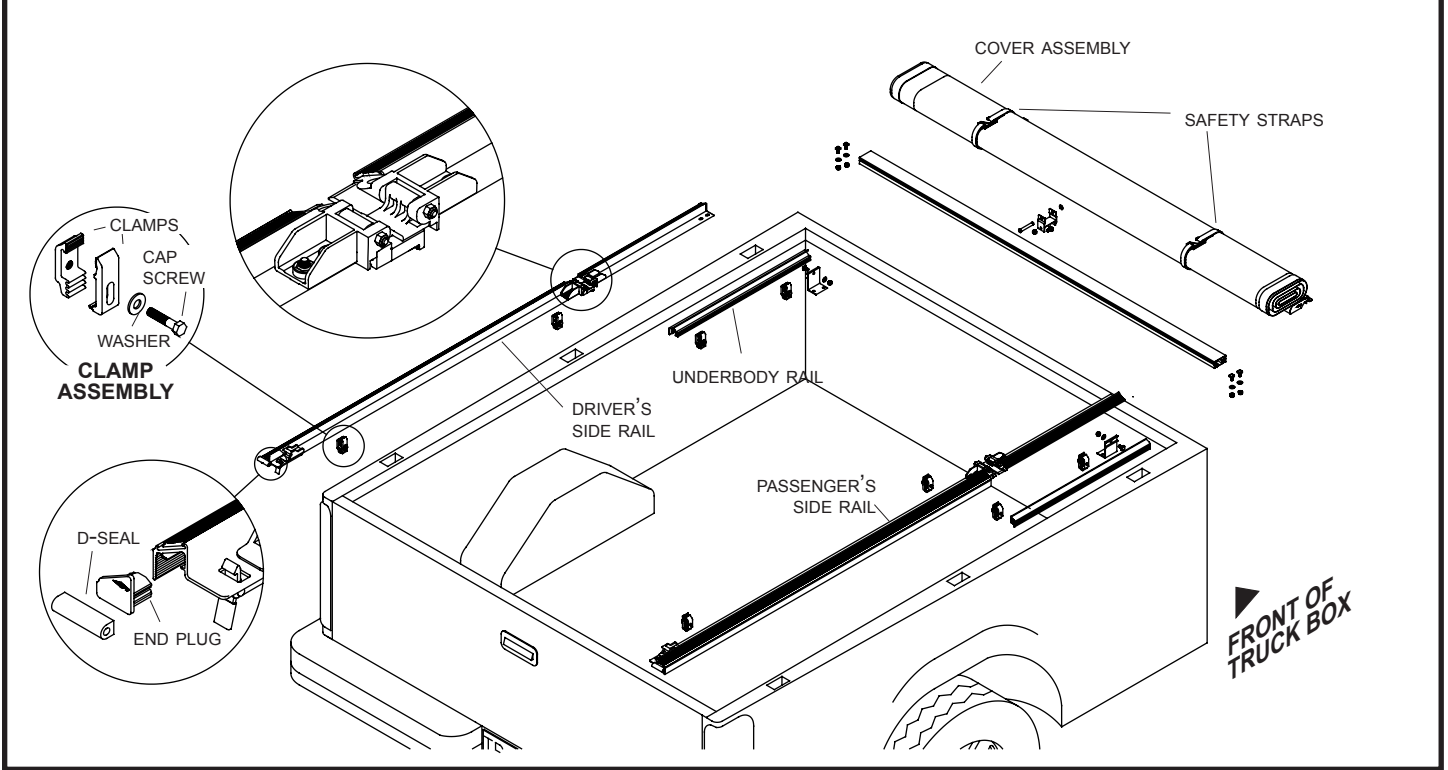

- 1 Install Side Rails:** With tailgate closed, align side rails flush with pickup bed rails and level with each other. Lightly compress D-seal against tailgate. Clamp side rails to bed rails, placing two clamps on fixed portion of rails near ends of rails. Tighten securely.

High Bed Caps -

Adjust side rail height as needed to get a good seal at front and back of cover.

⚠ WARNING Tighten clamps securely on side rails before driving vehicle.

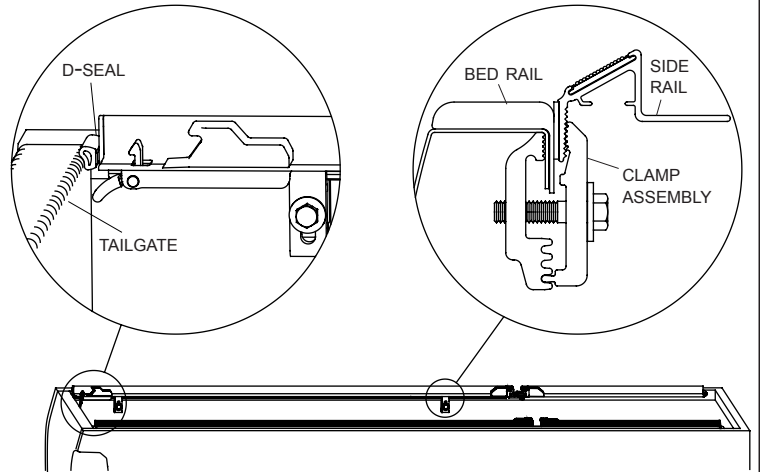

- 2 Level Side Rails:** For optimal latching performance and cover fit, side rails must be level. Raise or lower male clamps until rails are level, then tighten clamps.

Clamp configurations shown are for reference only and are not intended to be standard for all pickups.

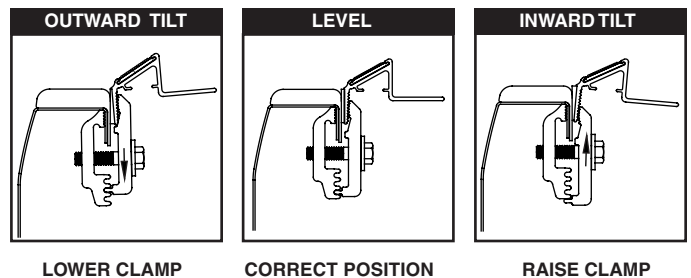

SIDE RAIL AND COVER INSTALLATION (continued)

3 Install Underbody Rails: Fold back hinged portion of side rails, and stand inside pickup bed to install underbody rails.

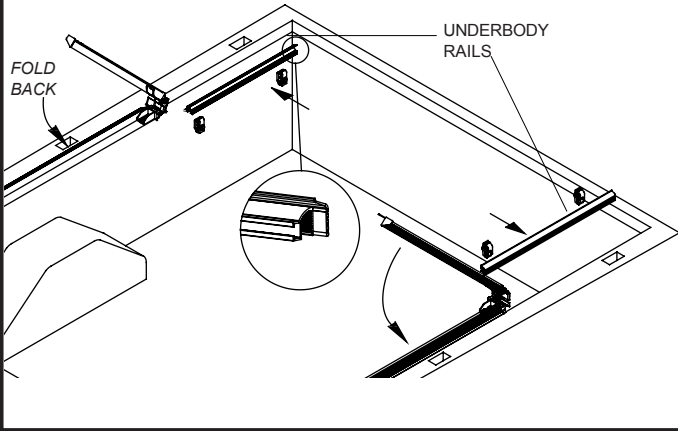

4 Install Underbody Rails: Position underbody rails flush with Truxedo® Deuce side rails as shown. Clamp underbody rails to pickup bed.

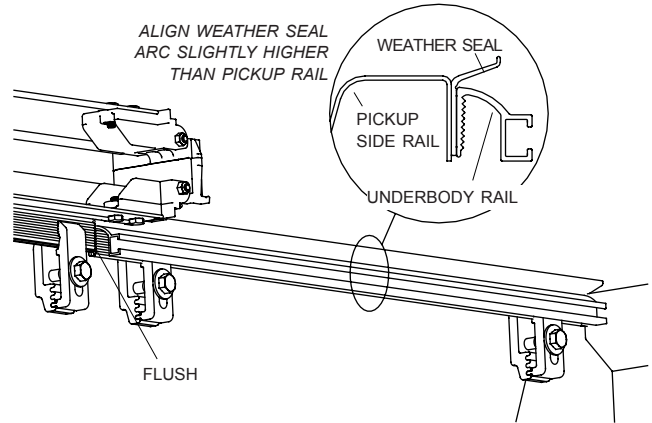

5 Assemble Side Brackets to Crossmember: Insert square bolt heads into crossmember channels. Lightly snug up bolts but do not tighten.

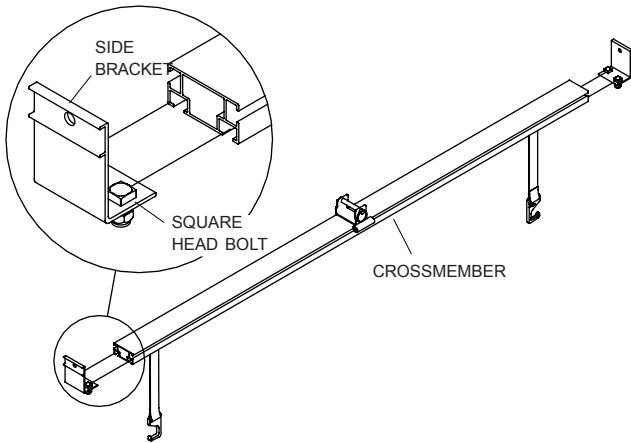

6 Assemble Crossmember to Underbody Rails: Insert square bolt head into channel on underbody rail. Fasten one end of crossmember assembly to bolt with flat washer and lock nut. Repeat on opposite side of pickup.

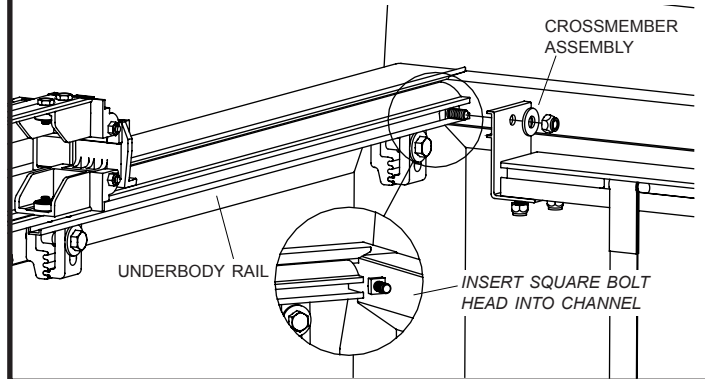

7 Align crossmember side bracket close to front of pickup bed. Make sure crossmember does not rub against front bulkhead.

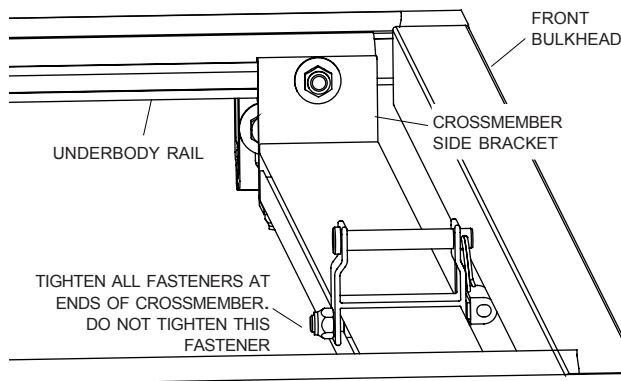

8 Set cover assembly on top of side rails and rotate front rails back as shown.

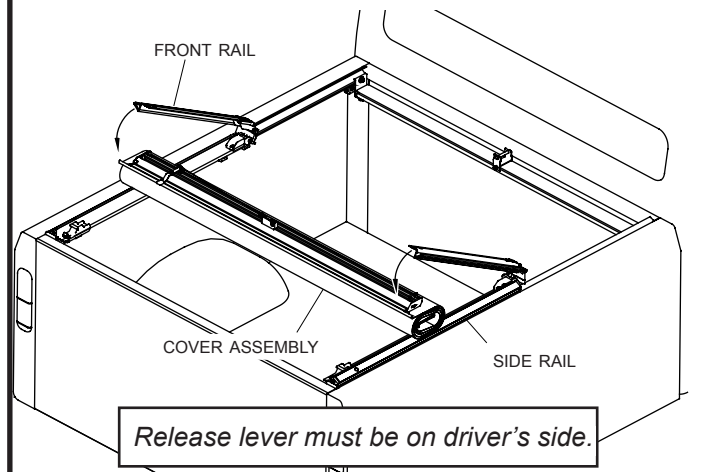

SIDE RAIL AND COVER INSTALLATION (continued)

9 Align front rails on cover assembly and insert bolts through slotted holes in front rail. Install washer and hex nut. Ratchet nuts in place but do not tighten.

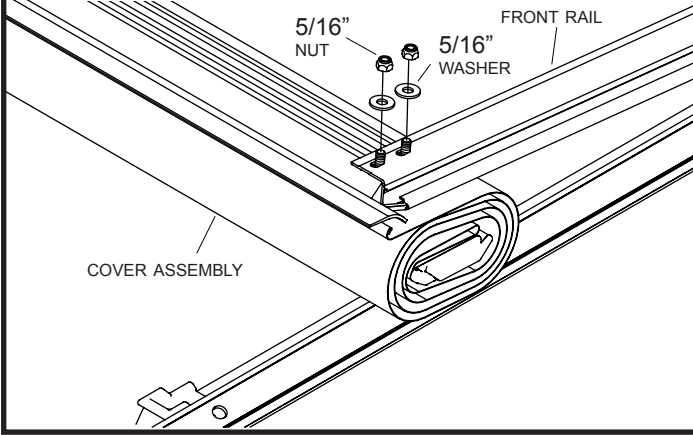

10 Standing inside pickup bed, carefully lift and rotate front rails and cover assembly closed.

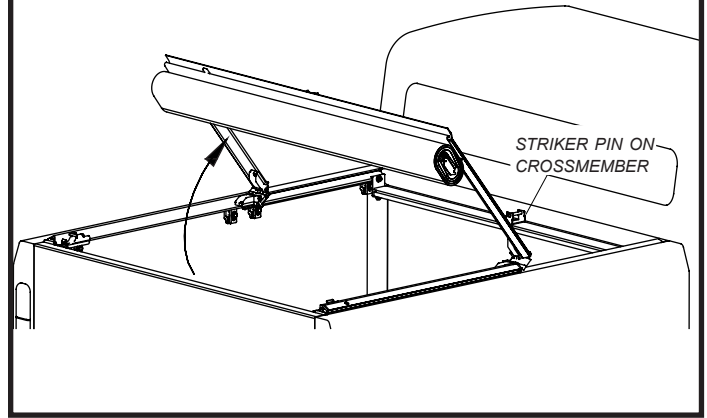

11 Align striker pin on crossmember with rotary lock latch on cover. Lift cover assembly slightly and slide striker bracket to align striker pin with rotary lock latch.

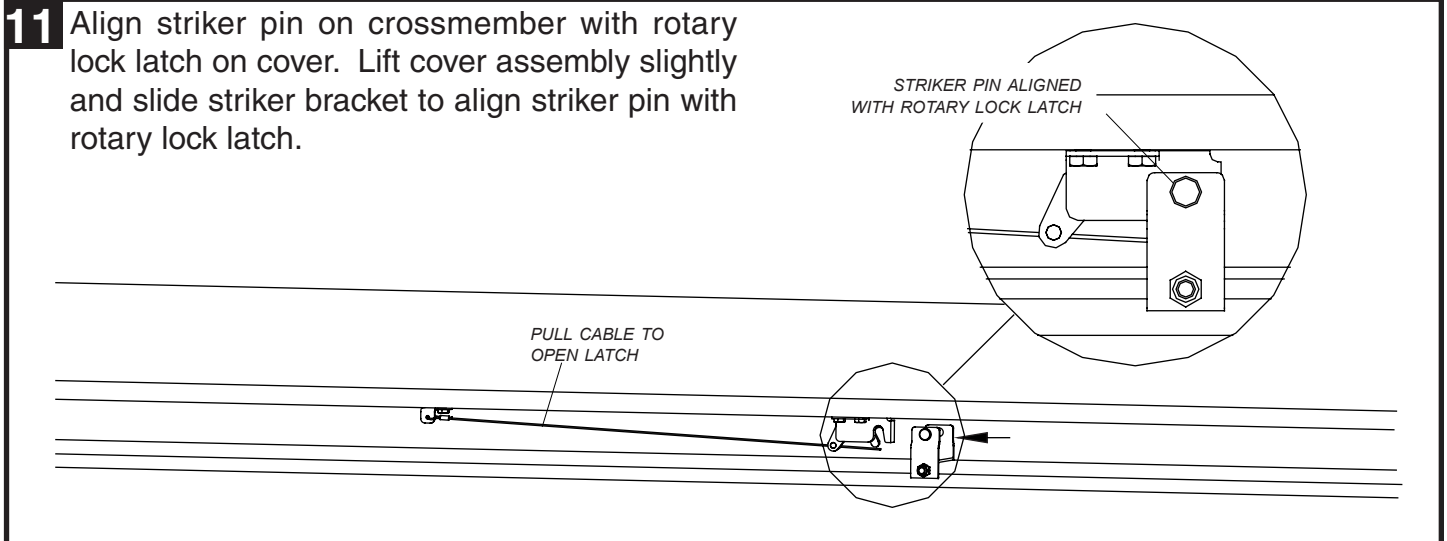

12 Square Up Cover Assembly: Position rails to maintain even spacing with pickup.

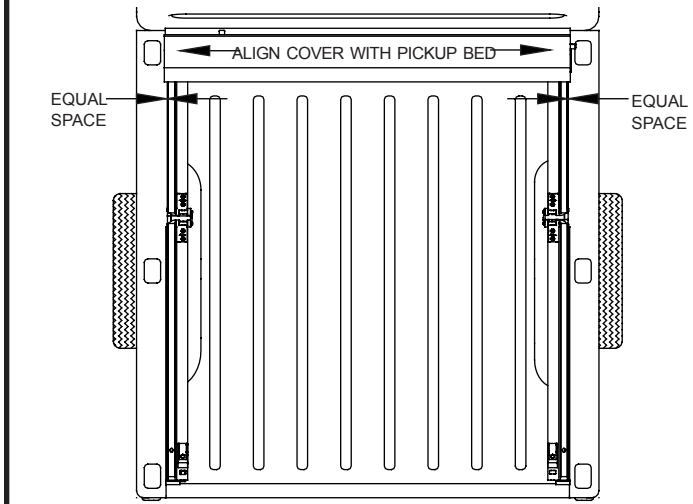

13 Tighten All Fasteners Securely: Tighten fasteners shown below using box end of wrench.

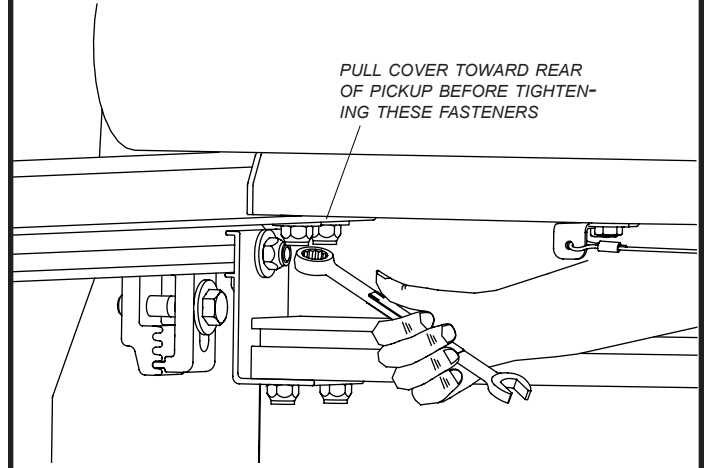

- 14 Adjust Striker:** Align striker pin with rotary lock latch and tighten fasteners. Cover will not latch unless rotary lock latch is centered over striker pin.

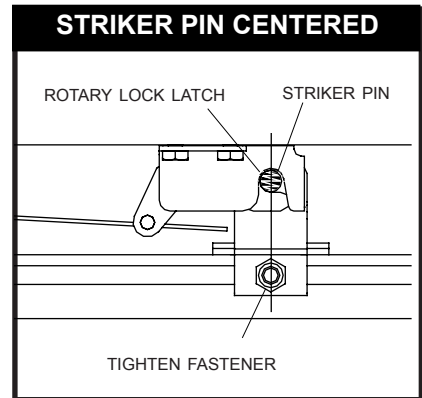
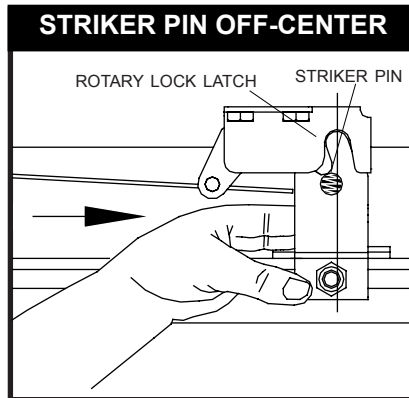
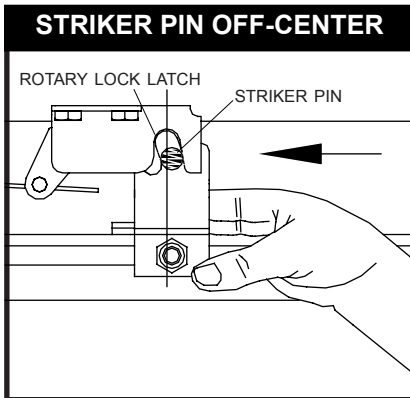

OPEN AND CLOSE COVER

- 15 Close Cover:** Unroll cover toward tailgate and rest bows on side rails. Rotate header into header stops and press down to lock toggle into header. **Release Cover:** Pull back on toggle. Roll cover toward cab to open. For best results, leave cover fastened to side rails while opening.

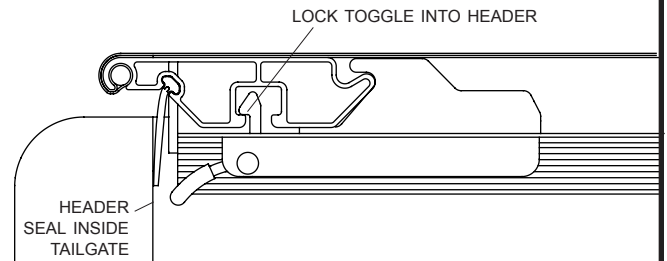
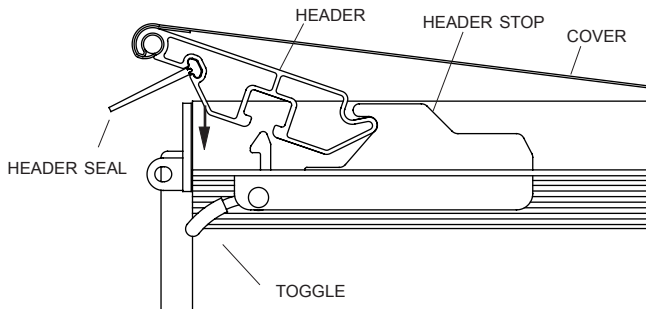

If tailgate has a key lock, TruXedo® Deuce is secured until tailgate is unlocked and opened.

In cold weather conditions or with some accessories, it may be preferable to close the cover before closing the tailgate. Header seal may be placed across top of tailgate.

ADJUST TENSION IF NECESSARY

- 16 Adjust Tension if Necessary.**

With cover closed, unlatch and open front of cover. Loosen nuts and adjust cover forward or backward. Retighten nuts.

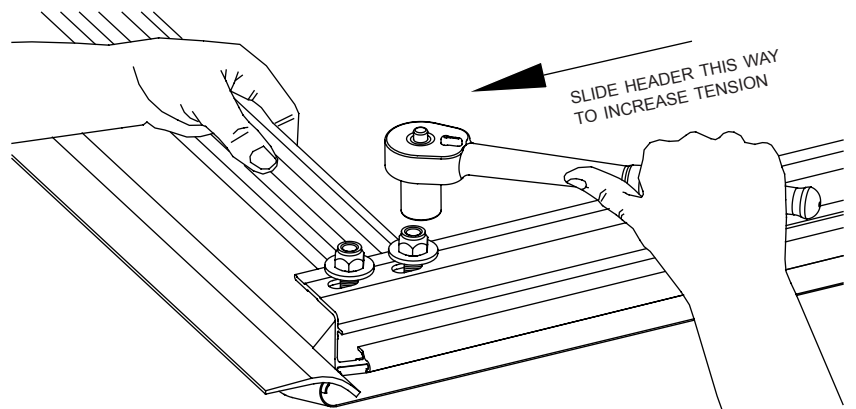

OPEN AND CLOSE COVER (continued)

17 To Open: Press latch to release front hinged portion of cover. Lift up and flip cover back to open.

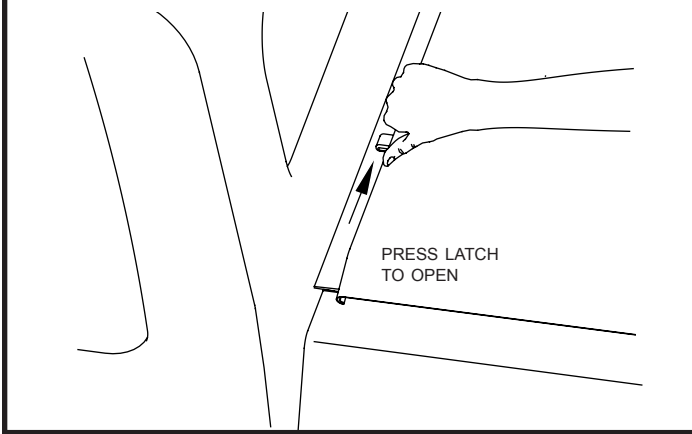

18

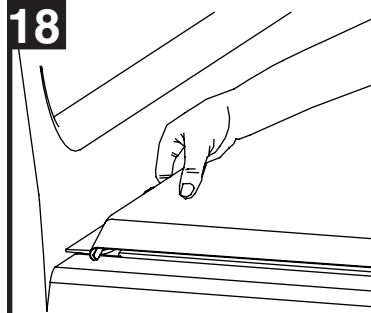

To Close: After closing front hinged portion of cover, try to lift up on front of cover to make sure latch is secured and cover will not open.

PN 1703821-Rev B

WARNING
Do not drive vehicle when hinged portion of the cover is flipped open.
Cover can separate from vehicle and could cause property damage, personal injury or death. Always lift upward on the cover after closing to make sure that the cover is securely latched.

Patents Pending

19 Secure Shur-Bond™ fasteners on one side rail, by pressing along full length of rail. Pull cover tight across pickup bed, and secure opposite side rail.

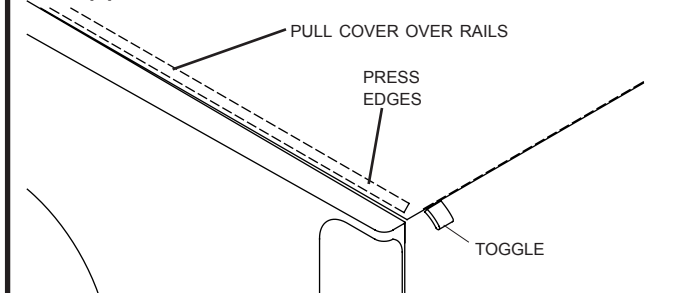

To prevent wind lift, secure Shur-Bond™ VELCRO® brand fasteners along entire length of both side rails before driving vehicle.

20 Secure cover open by hooking safety straps to front loops.

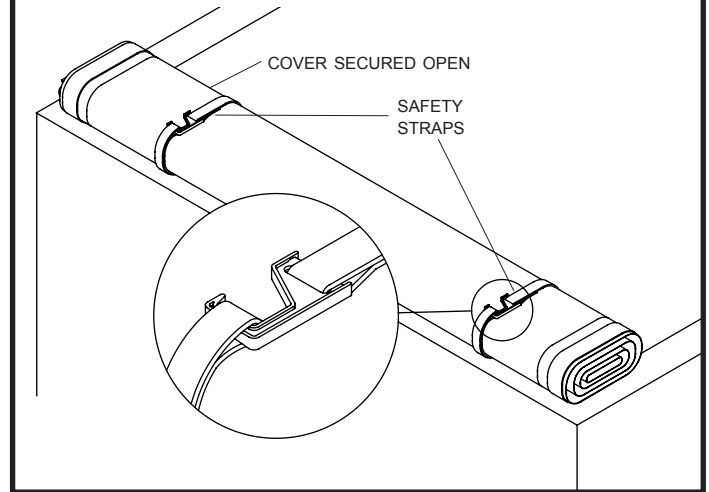

- To prevent accidental release of tailgate header, ensure header is securely latched to side rails on both sides of pickup bed before driving vehicle.
- To prevent wind lift, secure VELCRO® brand fasteners along entire length of both side rails before driving vehicle.

ADDED SECURITY DEVICE

21 To Engage: Roll cover opened from tailgate. Slide plastic knob against latch lever and tighten knob.

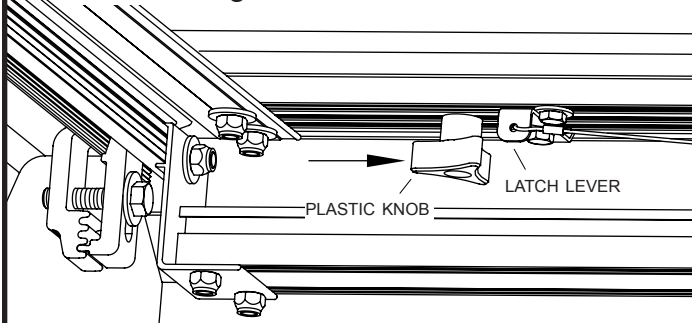

TROUBLE SHOOTING

TAILGATE HEADER WILL NOT LATCH:

Check side rails to make sure they are level. See Step 2. Check position of side rails on pickup box, they may be positioned too low. See Step 1.

FABRIC COVER IS TOO TIGHT OR TOO LOOSE:

See Step 16 to adjust cover tension.

* VELCRO® is a registered trademark of the Velcro companies.

Specify length or make and model of vehicle to inquire about headers, cover, side rails, or bows.

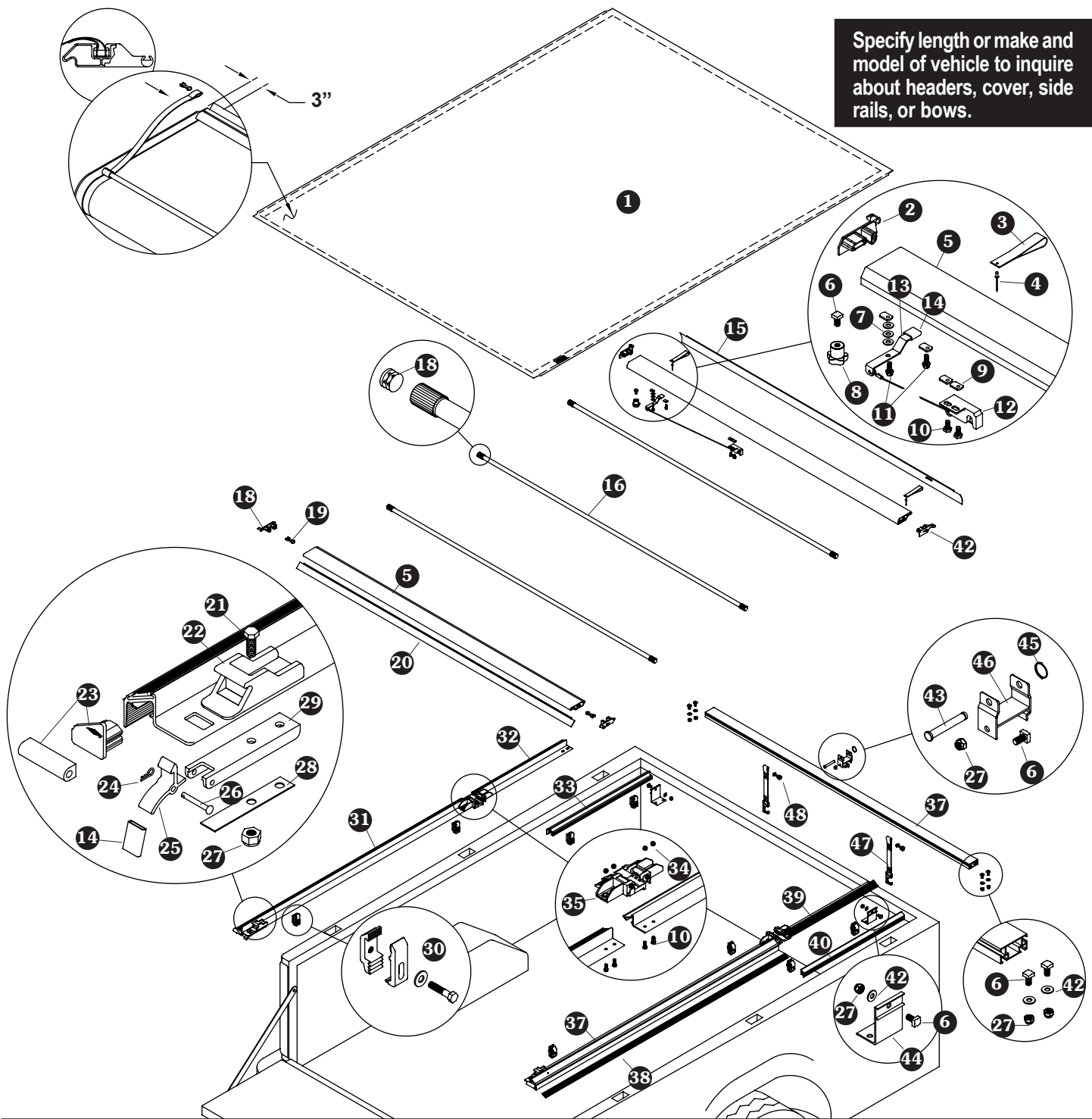

TRUXEDO® DEUCE REPLACEMENT PARTS

1	*	Deuce® Replacement Cover	18	1115372	Header End Plugs (Set of 2)	34	1701543	Nylon Lock Nut, 1/4"
2	1703765	Header End Plug, LH	19	1115354	Header Insert Safety Clip	35	1116695	Hinge Assembly, Spring Loaded
3	1115353	Header Safety Strap	20	*	Header Seal, Tailgate	36	*	Crossmember
4	1703344	Blind Rivet, 1/8" x 3/16"	21	1702926	Cap Screw, 5/16" x 7/8"	37	*	Side Rail, Passenger's Side
5	*	Black Header	22	1702801	Header Stop	38	*	Shur-Bond™ VELCRO® Fasteners
6	1703595	Cap Screw, Sq Hd, 5/16" x 5/8"	23	1115373	Side Rail End Plugs (Set of 2)	39	1703752	Side Rail Front, Pass. Side
7	1703854	Spacer Washer, 7/8" OD	24	1702611	Cotter Pin, 3/64" x 19/32"	40	1116900	Rail Underbody Assembly, Pass. Side
8	1703855	Plastic Knob	25	1703639	Toggle	41	1703765	Header End Plug, RH
9	1703771	Weld Nut, Tab, 1/4"	26	1702610	Clevis Pin, 3/16" x 1 1/4"	42	1700428	Flat Washer, 5/16"
10	1702670	Cap Screw, 1/4" x 1/2"	27	1700419	Nylon Lock Nut, 5/16"	43	1703768	Striker Pin, 3/8" x 2 1/2"
11	1703901	Cap Screw, Flange Hd 1/4" x 3/4"	28	1114773	Flat Spring, 5/8" x 3 7/8"	44	1703851	Crossmember Bracket, Attach
12	1703767	Slam Latch Rotary Lock	29	1703650	Latch Main Frame	45	1703863	Cotter Ring, 1" OD
13	1703841	Latch Lever, Cable Pull	30	*	Aluminum Clamp Assy	46	1703847	Striker Bracket
14	1703265	Toggle Cap, Vinyl	31	*	Side Rail, Driver's Side	47	*	Safety Strap
15	*	Header Seal, Cab	32	1703751	Side Rail Front, Driver's Side	48	1116797	Header Insert Safety Clip, 5/16"
16	*	Black Bow	33	1116901	Rail Underbody Assembly, Driver's Side			
17	1701595	End Plug, 1" OD						

* Please specify length or make and model of vehicle.

LIFETIME WARRANTY

Shur-Co. warrants that all new, unused products are free from defects in material and workmanship. This Warranty is effective if the product is properly installed and used for the purpose intended for the life of the product. It applies to the original buyer only. Shur-Co.'s obligation under this Warranty is limited to repairing, or at its option, replacing any part that is returned, transportation prepaid, to Shur-Co., Yankton, South Dakota, if the product is, in our judgment, defective. All materials must be accompanied by an RMA (Returned Material Authorization) number requested and authorized in advance of returning the materials. Shur-Co. shall not be liable or responsible to supply or pay labor to replace any part found defective, nor shall it be liable for any damages of any kind or nature to person, product, or property.

There are no Warranties for used products or products that have been repaired, altered, modified, subjected to misuse, negligence, accident or ordinary wear and tear. Call 1-877-878-9336 for complete details.

Shur-Co. products are sold without any express warranty except as set forth above. Shur-Co. is not obligated to honor warranty claims if Genuine Shur-Co. parts are not utilized.

DIRECT ALL WARRANTY CLAIMS TO SHUR-CO. AT 1-877-878-9336



WARNING

Tighten clamps securely on side rails before driving vehicle, to prevent cover from blowing off.

SAFETY INSTRUCTIONS

1. Do not place objects on or against cover or framework.
2. Do not tie cargo to Truxedo® Deuce framework.
3. **Never** allow children or pets to occupy pickup box while cover is closed.
4. Cover is not airtight. Special care is required to keep cargo clean and dry.
5. Fabric cover won't prevent theft of contents inside truck box.
6. Cover must be rolled fully open and secured with safety straps when towing vehicle backwards.
7. Never drive vehicle while hinged front of cover is open.

OWNER/USER RESPONSIBILITIES

It is the responsibility of the owner/user to read this manual and comply with the operating procedures. The owner/user is also responsible for inspecting their Truxedo® Deuce cover, and for having parts repaired or replaced when worn or damaged.

Failure to follow safety instructions and warning labels could result in failure of your cover system and/or personal injury.

MESSAGES TO INSTALLER

- Always wear safety glasses and/or other necessary protective equipment when installing your Truxedo® Deuce.
- These instructions are complete for most pickup models. Additional instructions are included, if required for your pickup. Please read entire manual before installing your Truxedo® Deuce.

COVER MAINTENANCE

Vinyl cover can be hand washed with mild soap and water or cleaned in a car wash. Thoroughly rinse cover to remove any soap residue. Cover can be treated with any vinyl protectant made for tonneau covers.

Never use silicon, petroleum, or citrus based products on your tonneau cover.

Questions?

Call our friendly customer service staff at Shur-Co. Automotive Toll Free:

1-877-878-9336
Mon - Fri 8 am - 5 pm CT

Register online at www.truxedo.com or mail this form to: Shur-Co., P.O. Box 713, Yankton, SD 57078-0713

Name: _____

Address: _____

City: _____ State: _____ Zip: _____

Phone Number: _____

Email Address: _____

Date Purchased: _____

Product Purchased:

Price Paid: _____

Original TruXedo

Dealer Name: _____

TruXedo Lo Pro QT

Pickup Make: _____

TruXedoPlus

Model: _____

TruXport

Year: _____

Truxedo Deuce

Shur-Co. Automotive

P.O. Box 713, 2209 Kellen Gross Dr., Yankton, South Dakota 57078
Call Toll Free: 1-877-TRUXEDO (1-877-878-9336) Fax: (605) 664-9304
Visit Us Online: <http://www.truxedo.com>

SHUR-CO.
AUTOMOTIVE

TRUXEDO
by Shur-Co. Automotive *Deuce*
Patented Product